

ONWA[®]

MARINE ELECTRONICS



MODEL

KS-200B

AIS Receiver Black Box



MODEL

KS-200B_N

AIS Receiver Black Box

**Can send AIS data via network*



AIS Technology

RS232

Electrical Interface
and Programming

NMEA0183

Interface

➤ AIS TECHNOLOGY

The ONWA AIS receiver receives all AIS data of nearby targets around your boat (*with suitable VHF Antenna*) able to Interpret incoming AIS data for CPA alert or AIS S.A.R.T emergency messages.

For KS-200B_N:

ONWA KS-200B_N is an external AIS Device that may be interface with your Marine Radar or GPS Chart Plotter capable to receive AIS data via RS232 port and Network Data.

KS-200B_N lets you track your vessel even at certain distance using IP address of the black box unit which you can monitor from your computer.

➤ SYSTEM CONFIGURATION

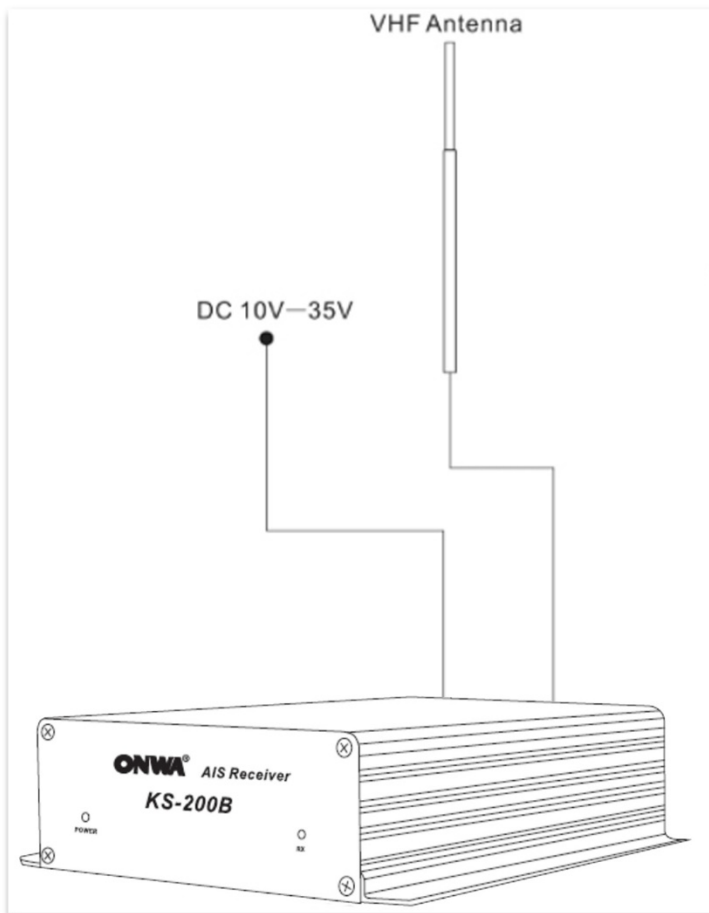

**Suitable VHF Antenna*
• **KA-159**
*(not included in the set,
specify when ordering)*



SPECIFICATIONS

Connectors

VHF Antenna connector PL259 female
Power/data connector 8 pins male

PHYSICAL

Dimension:
Weight:

207mm (length) x 155.8mm (width) x 50mm (height)
0.8kg

POWER

Input:
Power Consumption:

10~35VDC
0,35A nominal, 2A peak

Electrical Interface

RS232 38.4kbaud bi-directional

Environmental

Operating Temperature:

IEC 60945 (Cat C)
-25°C to +55°C

NMEA Sentence Supported

VDM, VDO

AIS CHARACTERISTICS

Frequency Rate: 156.025 MHz~162.025 MHz
Access Scheme: SOTDMA
Channel Bandwidth: 25 KHz
Modulation: GMSK
Number of AIS Receiver: 2

AIS Channel 1: CH 87B (161.975 MHz)
AIS Channel 2: CH 88B (162.025 MHz)
RX Sensitivity: < -123dBm @ 20% PER
RX Message Format: AIS Class A and B messages
Comply Standard: IEC-62287 IEC 62287-2 Ed. 2.0:2017

INTERCONNECTION DIAGRAM

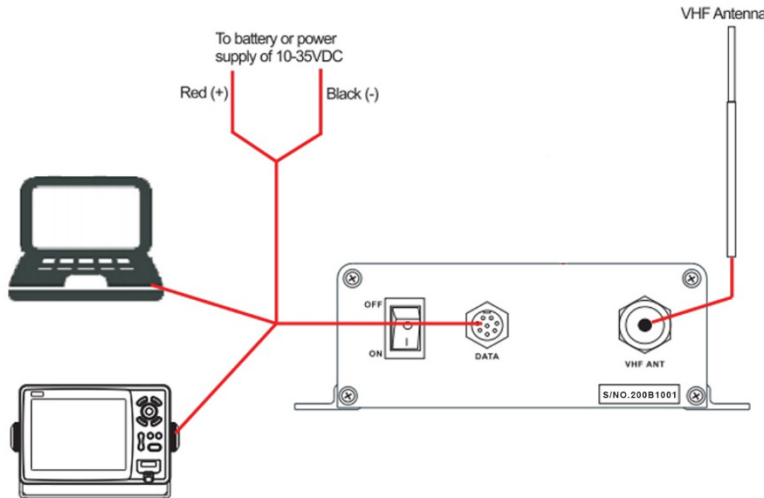

KS-200B CONNECTION DIAGRAM

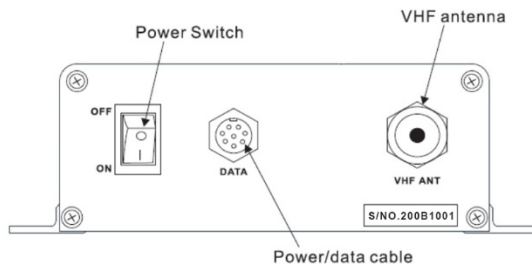

DIMENSION

